



PRODUCT SPECIFICATIONS

X Wrap High Perm is the only choice for demanding applications to protect from severe weather conditions and environments. **X Wrap High Perm** prevents the infiltration of air and water while still allowing for the escape of water vapor. The most unique feature is the *ALTA 360 degree* drainage that no other wrap in the world can give. The *ALTA 360 degree* drains in EVERY direction, no matter the final wall cladding, wood, vinyl, metal, brick, stone, cement sidings, stucco or EFIS. The incorporation of *ALTA 360 degree* makes **X Wrap High Perm** a one of a kind all weather protection layer for any type of construction with the assurance of quality and lifelong service.

- Custom print available in two colors, with one pallet minimum, at no additional cost
- Nationwide distribution

Roll Size	Rolls Per Pallet
36" x 100'	50 Rolls
36" x 150'	45 Rolls
54" x 100'	100 Rolls
54" x 150'	90 Rolls
9' x 100'	50 Rolls
9' x 150'	45 Rolls
9' x 195'	40 Rolls
10' x 100'	50 Rolls
10' x 150'	45 Rolls
10' x 195'	40 Rolls

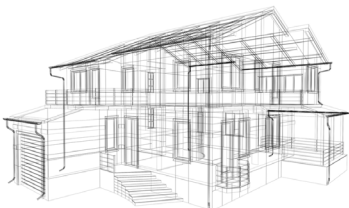

Product Specifications		Test Method
Air Penetration Resistance	0.00082	ASTM E2178 (cfm/ft2@1.57 psf)
	>2500	Gurley Hill (TAPPI-T460) (sec/100cm)
Water Vapor Transmission	385	ASTM E96 Method A (g/m2/24 hrs)
	55	(perms)
	465	ASTM E96 Method B (g/m2/24 hrs)
	67	(perms)
Water Penetration Resistance	>300	AATCC 127 (cm)
Basis Weight	2.2	TAPPI T-410 (oz/sq yd)
Thickness	8	ASTM D3776 (mils)
Breaking Strength	30	ASTM D882 (lb/in) MD
	30	ASTM D882 (lb/in) CD
Dry Tensile	45	ASTM D5034 (lb/in) MD
	45	ASTM D5034 (lb/in) CD
Tear Resistance (Trapezoid)	13.5	ASTM D1117 (lbs) MD
	12.5	ASTM D1117 (lbs) CD
Drainage Efficiency	>95%	ASTM E2273
	>95%	ICC-ES AC 235 Section 4.5
Surface Burning Characteristics	5 Class A	ASTM E84 Flame Spread Index
	45 Class A	Smoke Develop Index
Ultra Violet Light Exposure	180 days	



Installation Instructions

1. Install X Wrap High Perm over sheathing board, insulation board or directly to framing members.
2. Begin by aligning the bottom edge of the roll with the base of the wall, approximately 6" (152 mm) from a corner, folding several inches of the material under itself and fastening securely to a framing member or directly to studs. Be sure that the installation is horizontal on the vertical wall.
3. Unroll X Wrap High Perm with the printed side out, wrapping the entire building including door and window openings. Plastic cap nails or staples with a minimum 1" (25 mm) crown may be used to fasten the housewrap. Fasteners shall be spaced a maximum of 16" (406 mm) on center along studs and 8" (203 mm) on center along top and bottom sill plates. When installing X Wrap High Perm over non-structural sheathing products, foam insulation boards, fasteners must penetrate the framing members no less than 1/2" (13 mm) and spaced as noted above.
4. Using a modified "I" pattern, cut through X Wrap High Perm at door and window openings. Fold excess material inside the rough openings and fasten securely through the layers to a framing member.
5. If door frames and windows are already installed, then trim as close to them as possible and tape the X Wrap High Perm using Premium Seam Tape or equivalent to seal housewrap seams around openings. To ensure the 10 Year Limited Warranty, all seams must be taped using ONLY PREMIUM SEAM TAPE and all windows and doors must be flashed using approved flashing as in writing from AlphaPro Tech Engineered Products, Inc.
6. At the end of a roll and beginning of the next roll, fold the edge of the X Wrap High Perm under itself and attach to the structural sheathing or through the non structural sheathing to the nearest framing member. The seams must be overlapped a minimum of 6" (152 mm) unless otherwise specified for a particular application.
7. The installation of upper layers of X Wrap High Perm must overlap the lower layers no less than 2" (51 mm).
8. All vertical and horizontal laps should be taped using a standard grade contractor tape or equivalent to provide maximum results. Final side wall covering should be applied within 6 months of the application of X Wrap High Perm.